

Specification

Nominal Voltage	12V	
Nominal Capacity(20HR)	21.0AH	
Dimension	Length	181.5±1mm (7.14 inches)
	Width	77±1mm (3.03 inches)
	Container Height	167.5±1mm (6.59 inches)
	Total Height (with Terminal)	167.5±1mm (6.59inches)
	Approx Weight	Approx 6.0 kg (13.23lbs)
Terminal	T12	
Container Material	ABS	
Rated Capacity	21.0 AH/1.05A	(20hr , 1.80V/cell, 25°C/77°F)
	19.5 AH/1.95A	(10hr, 1.80V/cell, 25°C/77°F)
	17.8 AH/3.57A	(5hr, 1.75V/cell, 25°C/77°F)
	16.1 AH/5.36A	(3hr, 1.75V/cell, 25°C/77°F)
	13.2 AH/13.2A	(1hr, 1.60V/cell, 25°C/77°F)
Max. Discharge Current	300A (5s)	
Internal Resistance	Approx 15mΩ	
Operating Temp. Range	Discharge	-15~50°C (5~122°F)
	Charge	0~40°C (32~104°F)
	Storage	-15~40°C (5~104°F)
Nominal Operating Temp. Range	25±3°C (77±5°F)	
Cycle Use	Initial Charging Current less than	6.0A. Voltage
	14.4V~15.0V at 25°C(77°F)Temp. Coefficient	-30mV/°C
Standby Use	No limit on Initial Charging Current Voltage	
	13.5V~13.8V at 25°C(77°F)Temp. Coefficient	-20mV/°C
Capacity affected by Temperature	40°C (104°F)	103%
	25°C (77°F)	100%
	0°C (32°F)	86%
Self Discharge	Leoch DZM series batteries may be stored for up to 6 months at 25°C(77°F) and then a freshening charge is required. For higher temperatures the time interval will be shorter.	



Applications

- ◆ All purpose
- ◆ Uninterruptable Power Supply (UPS)
- ◆ Electric Power System (EPS)
- ◆ Emergency backup power supply
- ◆ Emergency light
- ◆ Railway signal
- ◆ Aircraft signal
- ◆ Alarm and security system
- ◆ Electronic apparatus and equipment
- ◆ Communication power supply
- ◆ DC power supply
- ◆ Auto control system

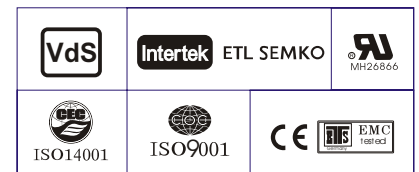

Constant Current Discharge (Amperes) at 25 °C (77°F)

F.V/Time	5min	10min	15min	20min	30min	45min	1h	2h	3h	4h	5h	6h	8h	10h	20h
1.85V/cell	40.0	30.7	25.4	22.0	17.0	12.5	10.6	6.25	4.89	3.97	3.24	2.81	2.27	1.89	1.04
1.80V/cell	53.7	39.2	30.7	26.0	20.1	14.6	11.8	6.82	5.26	4.24	3.48	3.02	2.40	1.95	1.05
1.75V/cell	60.5	43.1	33.6	28.0	20.8	15.1	12.4	7.07	5.36	4.34	3.57	3.10	2.45	2.01	1.06
1.70V/cell	66.6	47.0	35.8	29.4	21.7	15.7	12.8	7.25	5.50	4.45	3.66	3.16	2.48	2.05	1.08
1.65V/cell	73.5	50.7	38.1	31.2	22.9	16.1	13.1	7.35	5.74	4.61	3.76	3.23	2.52	2.09	1.09
1.60V/cell	81.1	55.1	40.8	33.3	24.2	16.8	13.2	7.67	5.91	4.75	3.89	3.30	2.54	2.11	1.10

Constant Power Discharge (Watts) at 25 °C (77°F)

F.V/Time	5min	10min	15min	20min	30min	45min	1h	2h	3h	4h	5h	6h	8h	10h	20h
1.85V/cell	73.1	56.7	47.5	41.5	32.4	24.1	20.4	12.1	9.53	7.77	6.35	5.53	4.48	3.75	2.06
1.80V/cell	97.1	71.6	56.6	48.3	37.7	27.8	22.7	13.1	10.2	8.25	6.79	5.90	4.73	3.86	2.08
1.75V/cell	107.2	77.5	61.0	51.5	38.8	28.6	23.6	13.6	10.3	8.40	6.94	6.05	4.80	3.96	2.10
1.70V/cell	114.7	82.5	64.3	53.7	40.1	29.6	24.3	13.9	10.6	8.61	7.11	6.16	4.87	4.03	2.13
1.65V/cell	124.7	88.2	67.8	56.6	42.0	30.1	24.7	14.0	11.0	8.87	7.28	6.28	4.93	4.11	2.16
1.60V/cell	134.4	93.6	71.3	59.6	44.0	31.2	24.8	14.5	11.3	9.13	7.49	6.39	4.97	4.15	2.17

Dimensions

T12 Terminal

Unit: mm [inches]

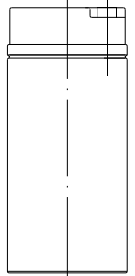
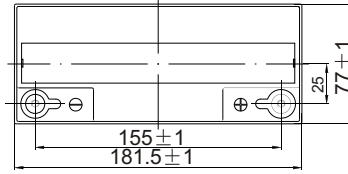
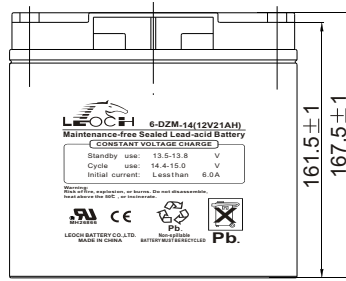
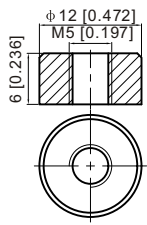

Discharge Characteristics

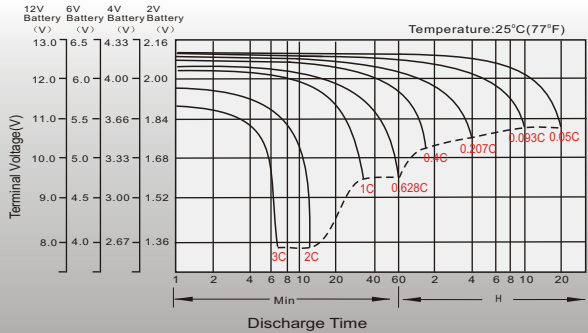

Float Charging Characteristics

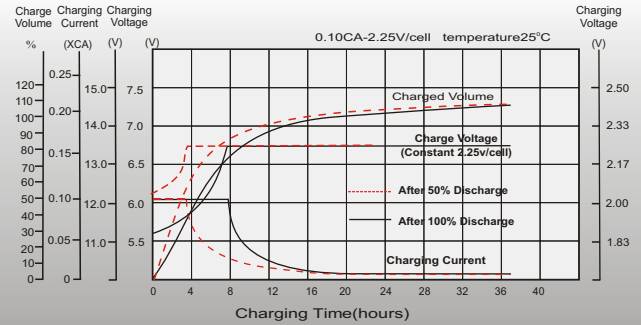

Temperature Effects in Relation to Batter Capacity

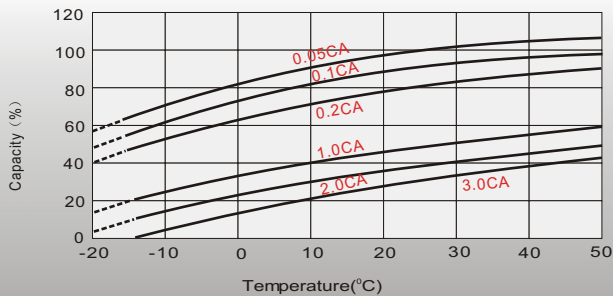

Effect of Temperature on Long Term Float Life

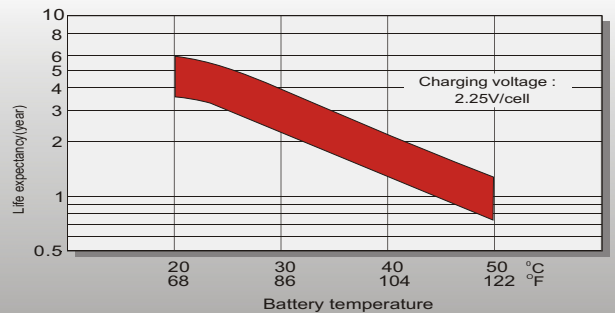

Cycle Life in Relation to Depth of Discharge

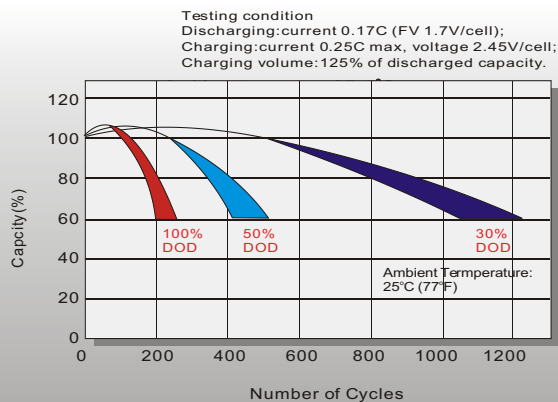

Self Discharge Characteristics

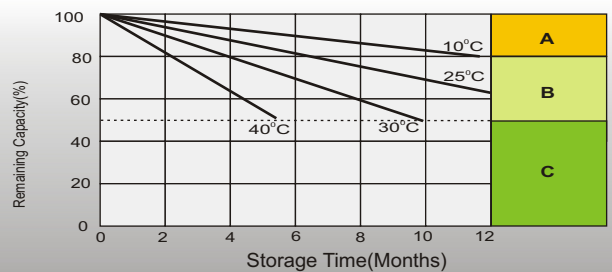

- A** No supplementary charge required (Carry out supplementary charge before use if 100% capacity is required.)
- B** Supplementary charge required before use. Optional charging way as below:
 1. Charged for above 3 days at limited current 0.25CA and constant volatge 2.25V/cell.
 2. Charged for above 20hours at limited current 0.25CA and constant volatge 2.45V/cell.
 3. Charged for 8-10hours at limited current 0.05CA .
- C** Supplementary charge may often fail to recover the capacity. The battery should never be left standing till this is reached.

Sales Office

China sales office:

Add: 5th Floor, Xinhua Bldg., Nanshan Blvd.,
 Nanshan, Shenzhen, China. 518052
 Tel: +86-755-26067200 (100 lines)
 Fax: +86-755-26067269
 E-mail: battery@leoch.com

North America sales office:

Add: 19751 Descartes, Unit A,
 Foothill Ranch, CA 92610, USA
 Tel: 949-588-5853
 Fax: 949-588-5966
 E-mail: sales@leoch.us

Europe sales office:

Add: LaCampagna House. Main Road.
 Gloucester. GL2-8JH. United Kingdom
 Tel: +44(0) 1452 751016
 E-mail: malcolm@leoch.com